



Honeywell Wireless Chimes - Supplementary Setup Instructions

How to link a Push to a Chime

Step 1 Fit battery into the push



Fit battery into the Doorbell, as shown below or for Plug-in Doorbell plug into mains socket

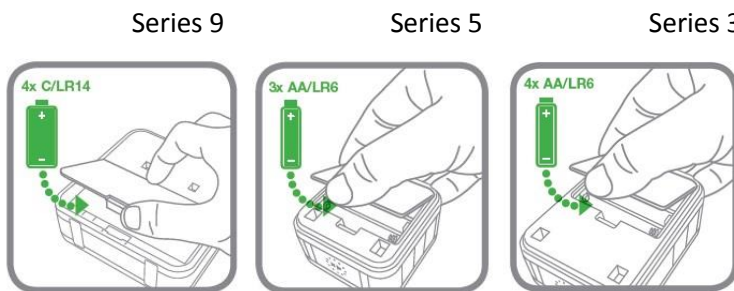

Step 2 Linking a Door push to the Doorbell

The Door push and Chime are supplied as a set from the factory, the below process should be followed for adding any additional pushes.

Press button  on the Doorbell, the doorbell will indicate that it is in linking mode with a rotating amber halo effect. (For product without Halo a small amber led will flash on the side of the doorbell)



Press push





How many pushes can be linked to one chime?

Honeywell chime allow up to 6 wireless push buttons to be connected depending on the model. Please refer to the table below,	
Series 3 (DC313xx)	2 wireless push buttons
Series 5 (DC515xx)	4 wireless push buttons
Series 9 (DC917xx)	6 wireless push buttons

The Doorbell with Halo will also show the default halo colour, if the user wishes to change the halo colour you have up to 12 seconds to select another colour by pressing the sun symbol button





Step 3. Push is now linked to the Doorbell, it is now ready for use.

How to select the tune of the Chime / Push Combination

The Doorbell will play the default tune, if the user wishes to change the tune user have up to

12 seconds to select another tune by pressing the Tune button. 

Note: The number of tunes available depends on the model and this will be available on the front of the packaging.

	Hello	Ding Dong	Westminster	Marimba	Piano	Bell	Telephone	Soft Alert
	●	●					●	●
	●	●	●	●			●	●
	●	●	●	●	●	●	●	●

Note: If the user wishes to change the Tune or Halo at a later date this is possible.

First press the push you wish change and you have up to 12 second to change the tune or Halo colour



How to change Tune?



	Hello	Ding Dong	Westminster	Marimba	Piano	Bell	Telephone	Soft Alert
	•	•					•	•
	•	•	•	•			•	•
	•	•	•	•	•	•	•	•

Note: when only one push is in use it is possible to change the tune directly at the Doorbell.

To change the Halo colour, please follow the below graphics sequence from left to right,

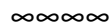



Series 9 (DC917) Notes

USB Power Option:

Series 9 Chimes with a USB socket can be powered from a standard USB power supply or port instead of batteries. The USB power supply is not supplied with the chime. A standard third party USB power supply with an output of 5Vdc 500mA can be used. The USB power supply will not charge any batteries left in the chime.

MP3 Tunes Option:

In addition to the standard tunes pre-programmed in the chime, Series 9 Chimes allow the download of multiple MP3 files to be used as custom tunes.

The total memory capacity for MP3 files is 15MB. The first 15 seconds of the selected MP3 file will be used as the tune. To maximise the number of tunes that can be downloaded, MP3 files with a length of 15 seconds can be used.

Additional Information

Product datasheets, Quick Start Guides, Safety data sheets and additional information for all models are available on the following Website: <http://livewell.honeywell.com/au/doorbells/>